

Welcome to

THE TOLBOOTH MUSEUM

If you have time when you leave, cross Castle Street and look back from across the road: you will be able to see the top of the 17th century sandstone spire peeking out above the granite frontage of the Town House. This is a glimpse of Aberdeen from before it was the 'granite city'.

School or party visits can be arranged by contacting Chris Croly on (01224) 337706. A guidebook to this building is available.

We hope you have enjoyed your visit to The Tolbooth Museum, and that you will also take the opportunity to see the City's Art Gallery and Museum close by:

Aberdeen Art Gallery

Schoolhill
Aberdeen
Open Tuesday to Saturday 10am-5pm
Sunday 2pm-5pm
Admission Free
Tel (01224) 523700

Aberdeen Maritime Museum

Shiprow
Aberdeen
Open Tuesday to Saturday 10am-5pm
Sunday 12noon-3pm
Admission Free
Tel (01224) 337700

The Tolbooth is one of Aberdeen's oldest buildings, a type which is central to the history and development of Scotland's Royal Burghs. The earliest parts of it date from the beginning of the 17th century, and there has been a Tolbooth near this site since the late 14th century. The Tolbooth was a place where tolls and taxes were collected, and within which the burgh council held their meetings. Aberdeen City Council still meets in the Town House, next to the museum, so it can be said that the Tolbooth has been the seat of local government for 600 years.

Correctly speaking, you are not really standing in the Tolbooth however, but in the wholly atmospheric Wardhouse, which was built between the years 1616 and 1629 as a prison to accommodate those warded to await trial and punishment. Confusingly, when the Tolbooth proper was demolished in the 19th century, to make way for a larger civic building next door, the Wardhouse was left intact, and became known as the Tolbooth.

The Tolbooth Museum, as we shall continue to call it, is a very complicated structure: for example in the entrance hall alone you can see remnants of 17th, 18th, 19th and 20th century building work.

During your visit you will find displays covering the development of the City of Aberdeen and the history of crime and punishment in the burgh. If you see everything, you will have climbed 86 stairs and visited six rooms on three floors, including the entrance hall. There is much to look at, hear, absorb and experience, but if you do find the steep, narrow stairs difficult, ask a member of staff about the video presentation available at the entrance.

You can get the best idea of the building and of how it fits into the 19th century Town House complex from outside, by walking a little way along Lodge Walk, the lane immediately adjacent to the main entrance to the museum. From there you can see something of the construction of the four storey Wardhouse tower, with its solid prison exterior.



**ABERDEEN ART GALLERY
& MUSEUMS**

www.aagm.co.uk

THE TOLBOOTH MUSEUM

Floor Plans

GROUND FLOOR

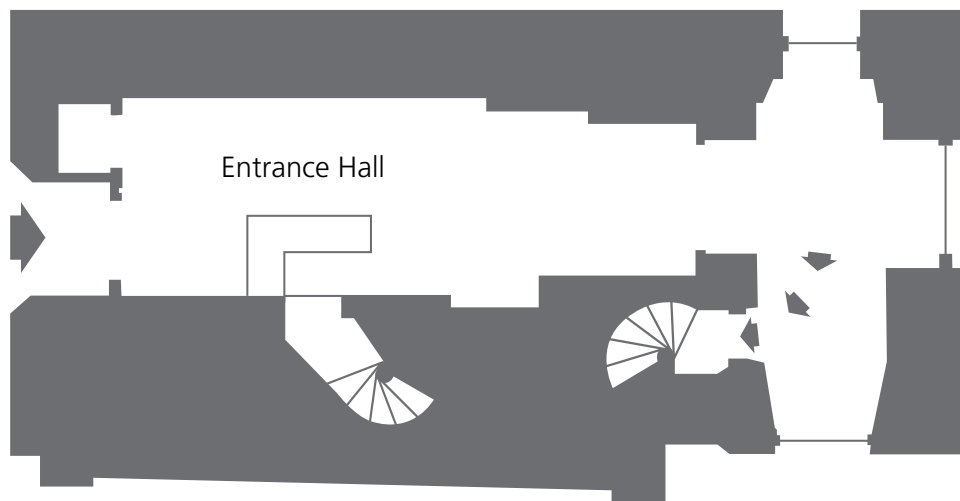

Note that there is now no first floor as it was removed between 1818-1820 to create the lofty entrance corridor.

SECOND FLOOR

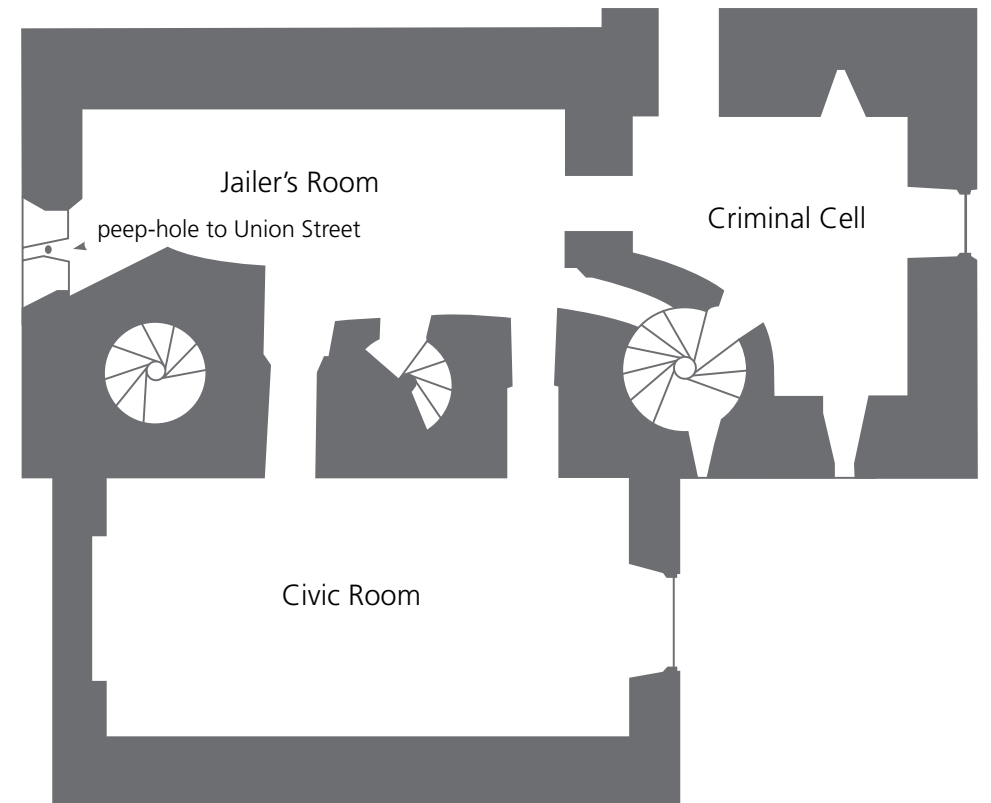

THIRD FLOOR

